

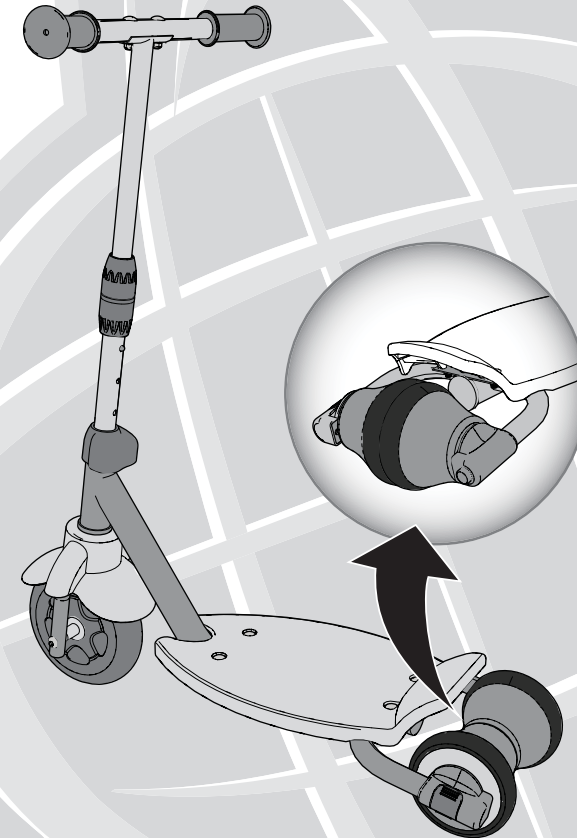

# GROW SCOOTER

## OWNER'S MANUAL



**THIS MANUAL CONTAINS IMPORTANT SAFETY, ASSEMBLY, OPERATION AND MAINTENANCE INFORMATION.**

**PLEASE READ AND FULLY UNDERSTAND THIS MANUAL BEFORE OPERATION.**

**SAVE THIS MANUAL FOR FUTURE REFERENCE.**

# STOP-ALTO-ARRET

See back page for Customer Service Information

Consulte el reverso para Servicio de Información al Cliente

Voir les pages verso pour des renseignements sur le service à la clientèle

[ In the US ]

**PLEASE - BEFORE RETURNING TO STORE, CONTACT HUFFY CUSTOMER SERVICE. WE ARE GLAD TO ASSIST YOU WITH ANY PARTS OR ASSEMBLY PROBLEMS YOU MIGHT HAVE!**

For Fast Customer Service, go to:

<http://www.huffybikes.com/contact>

To Order Parts (US only), go to:

<http://www.huffybikes.com/parts>

OR TEL: 1 800 872 2453 (US only)

For email, go to <http://www.huffybikes.com/contact>

[ MEXICO ]

**ANTES DE DEVOLVER EL PRODUCTO A LA TIENDA, COMUNÍQUESE CON SERVICIO AL CLIENTE DE HUFFY. NOS COMPLACE AYUDARLO CON CUALQUIER PARTE O PROBLEMA DE ENSAMBLADO QUE PUDIERA TENER.**

Para obtener Servicio al Cliente Rápido, visite:

<http://www.huffybikes.com/>

O LLAME AL TEL: 01800 1483 391

(Mexico only)

Para correo electrónico, vaya [servicio@huffymex.com](mailto:servicio@huffymex.com)



[ CANADA ]

**VEUILLEZ NOTER : AVANT DE RETOURNER AU MAGASIN, COMMUNIQUEZ AVEC LE SERVICE À LA CLIENTÈLE DE HUFFY. NOUS VOUS AIDERONS VOLONTIERS AVEC TOUT PROBLÈME CONCERNANT LES PIÈCES OU LE MONTAGE!**

Pour un Service à la Clientèle Rapide, allez sur le site :

<http://www.huffybikes.com/contact>

To Order Parts (CANADA only), go to:

<http://www.huffybikes.com/parts>

OU appelez le 1 800 872 2453 (CANADA only)

Pour communiquer par courriel [huffycanada@huffy.com](mailto:huffycanada@huffy.com)

Check <http://www.huffybikes.com/home/globalcontact> for the current contact information

<http://www.huffybikes.com/home/globalcontact> para comprobar la información de contacto actual

Vérifier <http://www.huffybikes.com/home/globalcontact> pour les informations de contact actuelles

# Index

• Parts Assembly .....	3
• Safety Information .....	4-5
• Assembly .....	6-8
• Operation .....	9
• Maintenance .....	9
• Warranty .....	10
Helmet Warnings .....	11
Contact Information .....	Back Cover

## Tools Needed

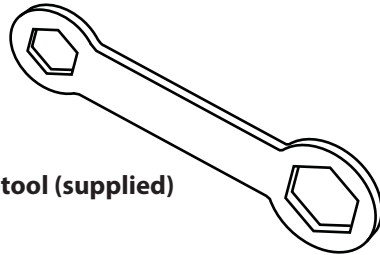

Wrench multi-tool (supplied)

# ! WARNING / ADVERTENCIA /

## AVERTISSEMENT :

**ALWAYS WEAR YOUR HELMET**

**WHEN RIDING THIS PRODUCT!**

**USE SIEMPRE EL CASCO AL MONTAR**

**ESTE PRODUCTO!**

**TOUJOURS PORTER VOTRE CASQUE LORSQUE**

**CIRCONSCRIPTION CE PRODUIT !**

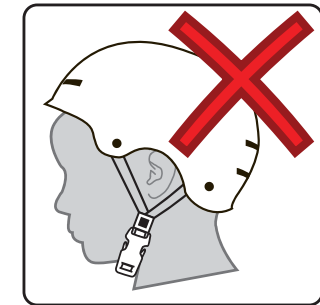
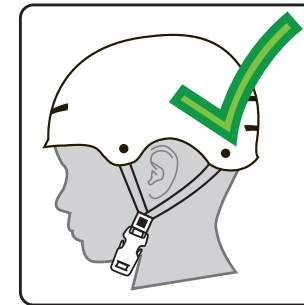

- Helmet should sit level on your head and low on your forehead
- Adjust the strap sliders below the ear on both sides.
- Buckle the chin strap. Adjust strap until it is snug.
- No more than two fingers should fit between the strap and your chin.
- A proper fitting helmet should be comfortable and not rock forward/backward or side to side.
- Always read the user manual that comes with your helmet to make sure it is fitted and attached properly to the wearer's head according to the fitting instructions described in the user manual.
- El nivel del casco se debe ajustar sobre su cabeza y cubrir su frente hasta abajo.
- Ajuste la correa controles deslizantes por debajo de la oreja en ambos lados.
- Hebille el barboquejo. Ajustar la tira hasta que quede bien ajustado.
- Solamente deben caber dos dedos entre la correa y la barbilla.
- El uso de un casco a su medida debe de ser cómodo y no estar moviéndose hacia delante o hacia atrás o de lado a lado.
- Siempre lea el manual del usuario que viene con su casco para asegurarse de que se encuentra instalado y conectado correctamente a la cabeza de acuerdo con el manual de montaje se describe en el manual del usuario.
- Casque devrait siéger niveau sur votre tête et faible sur votre front.
- Régler la sangle curseurs au-dessous de l'oreille des deux côtés.
- Boucle de la jugulaire. Régler l'attache jusqu'à ce qu'elle soit serrée.
- Pas plus de deux doigts devraient monter entre la sangle et le menton.
- Un bon raccord casque doit être confortable et pas rock avant/arrière ou de côté à côté.
- Toujours lire le manuel d'utilisation fourni avec votre casque pour s'assurer qu'il est monté et fixé correctement à la tête du porteur selon la notice de montage décrit dans le manuel de l'utilisateur.

## Limited Warranty

### General:

- Part or model specifications are subject to change without notice.
- This Limited Warranty is the only warranty for the product. There are no other express warranties.
- The only uses for this product are described in this manual.
- Warranty registration is not required.
- The Limited Warranty extends only to the original consumer and is not transferable to anyone else.

### What does this Limited Warranty cover?

This Limited Warranty covers all parts of the product except those indicated below as not warranted.

### What must you do to keep the Limited Warranty in effect?

This Limited Warranty is effective only if:

- Product is completely and correctly assembled.
- Product is used under normal conditions for its intended purpose (see the following section for excluded activities).
- Product receives all necessary maintenance and adjustments.
- Product is used for general transportation and recreational use only.

### What is not covered by this Limited Warranty?

This product is designed for recreational use only. This Limited Warranty does not cover normal wear and tear, normal maintenance items, or any damage, failure, or loss that is caused by improper assembly, maintenance, adjustment, storage, or use of the product.

### This Limited Warranty will be void if the product is ever:

- Used in any competitive sport
- Used for stunt riding, jumping, aerobatics or similar activity
- Modified in any way
- Modified with the addition of a motor
- Ridden by more than one person at a time
- Rented, sold, or given away

- Used in a manner contrary to the instructions and warnings in this Owner's Manual

Huffy will not be liable for incidental or consequential loss or damage due directly or indirectly from use of this product. Some States do not allow the exclusion or limitation of incidental or consequential damages, so the above limitation may not apply to you.

### What will Huffy do?

Huffy will replace, without charge to you, any part, or component found to be defective by Huffy.

### How do you get service?

Contact the Customer Service Department.

- See included list for Customer Contact information or visit [www.huffybikes.com/contact](http://www.huffybikes.com/contact).

### What rights do you have?

This warranty gives you specific legal rights. You may also have other rights which vary from State to State.

### How long does this Limited Warranty Last?

All components are warranted for 6 months from the date of purchase. Electronics and Wheels: 90 days.

## Part Assembly

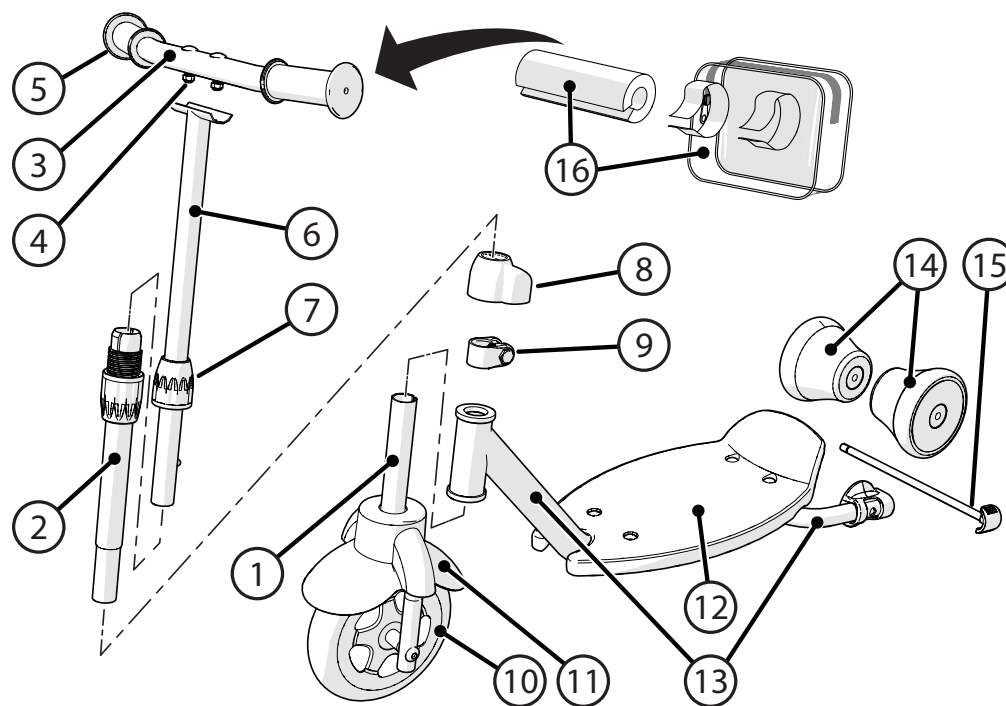

#	Description	#	Description
1	Fork	8	Clamp Cover
2	Bottom Steering Tube / Twist Clamp	9	Fork/Steer Tube Clamp
3	Handlebar	10	Front Wheel
4	Handlebar Hardware	11	Fender
	• Screw, Washer, Nut x2	12	Deck and Mounting Hardware
5	Grips (x2)	13	Main Frame
6	Top Steering Tube	14	Rear Wheels (x2)
7	Hand Twist Clamp	15	Rear Lock Axle
		16	Handlebar Bag/Pad (various models)

## Safety and Warning Information

### **WARNING TO AVOID SERIOUS INJURY:**

#### Product Specific Warnings:

- This product should only be used by persons 3 years and up.
- Maximum rider weight for this product is 27kg. (60 lbs).

If you have any questions regarding the operation of this product, please refer to this owners manual or call Customer Service  
- see Consumer Service contact info.

**ADDITIONAL SAFETY AND WARNING INFORMATION >>**

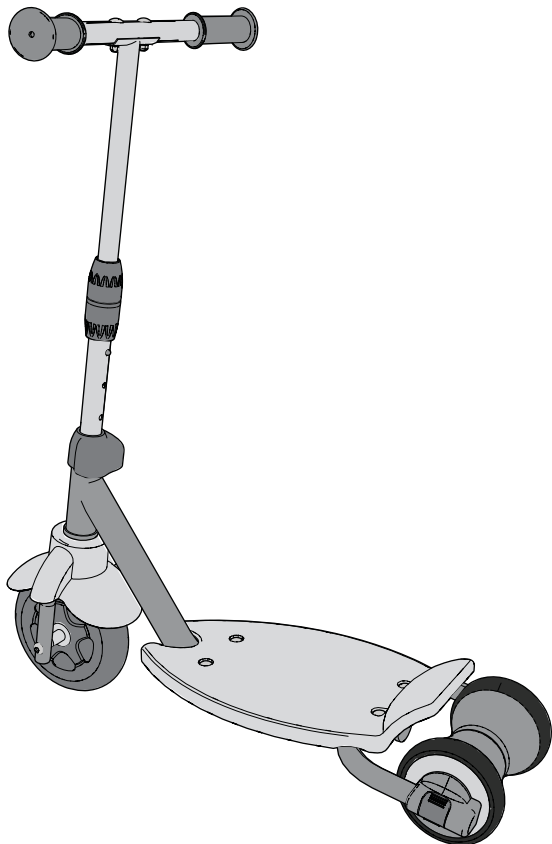

## Operating the Scooter

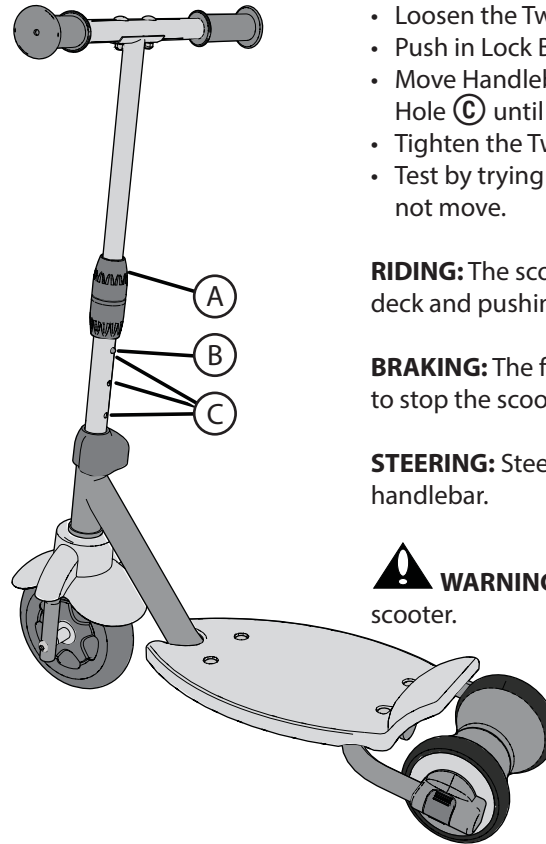

### ADJUSTING THE HANDLEBAR:

- Loosen the Twist Clamp (A).
- Push in Lock Button (B),
- Move Handlebar up or down to the desired Positioning Hole (C) until the Lock Button snaps into place.
- Tighten the Twist Clamp (A) hand tight.
- Test by trying to move Handlebar up or down. It should not move.

**RIDING:** The scooter is operated by placing one foot on the deck and pushing with the other foot.

**BRAKING:** The foot used to propel the scooter is also used to stop the scooter.

**STEERING:** Steering is accomplished by turning the handlebar.

 **WARNING:** Always wear shoes when riding the scooter.

## Repair and Service

### **WARNING:**

- Inspect the product frequently. Failure to inspect the product and to make repairs or adjustments, as necessary, can result in injury to the rider or to others. Make sure all parts are correctly assembled and adjusted as written in this manual and any "Special Instructions".
- Immediately replace any damaged, missing, or badly worn parts with original equipment.
- Make sure all fasteners are correctly tightened as written in this manual and any "Special Instructions". Parts that are not tight enough can be lost or operate poorly. Over tightened parts can be damaged. Make sure any replacement fasteners are the correct size and type.

**NOTE:** Have a bicycle service shop make any repairs or adjustments for which you do not have the correct tools or if the instructions in this manual or any "Special Instructions" are not sufficient for you.

## Changing from 3-Wheel to 2-Wheel Scooter

### STEPS:

- Push Release/Lock Button **(A)** and pull out Locking Axle **(B)**.
- Pull both Wheels **(C)** straight out.
- Turn each Wheel over so Tread is now in the center as shown **(D)**.
- Place together and insert between Rear Forks so that all holes line up.
- Reinsert Locking Axle **(B)** through Fork side, both Wheels and opposite Fork side.
- While holding IN Release/Lock Button **(A)**, snap Locking Axle firmly into place.

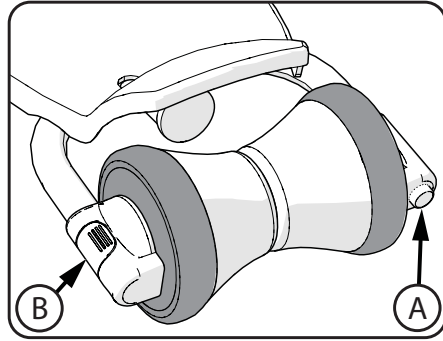

- To change Wheels back, do these steps again, but turn each Wheel so that Tread is on the outside.

### NOTES:

- To test, try to pull out Locking Axle. It should not release.
- Make sure Wheels turn freely after changing.

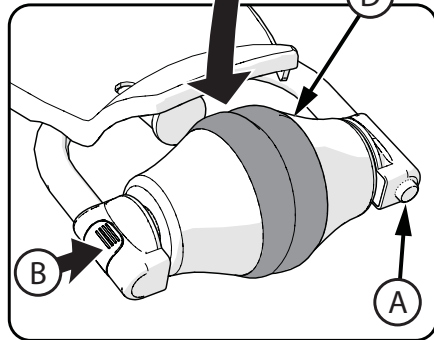
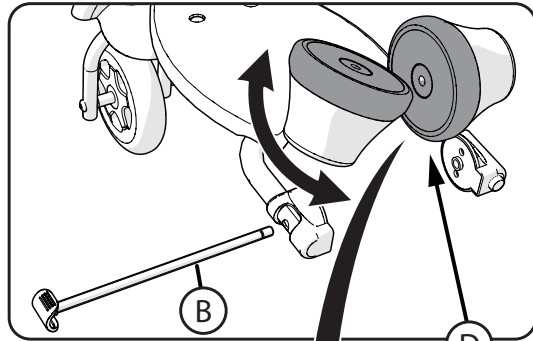
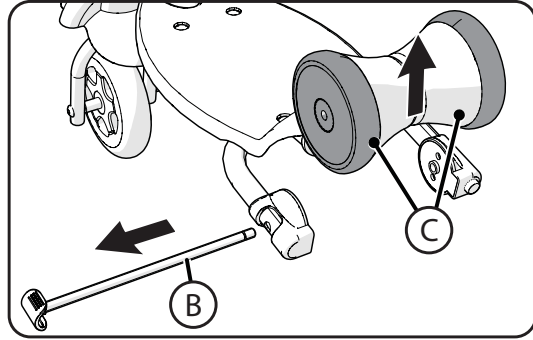

### ⚠️ WARNING:

2-wheel scooters are not as stable as 3-wheel scooters. Make sure your child can operate the scooter safely.

## Safety and Warning Information

This product, like all wheeled vehicles, will provide safe, enjoyable transportation and recreation when used and maintained properly. Like bicycling, skateboarding, and in-line skating, riding this product can be dangerous even under the best of circumstances. We do not want you to get hurt. Please follow these safety rules.

**⚠️** This symbol is important. It is the WARNING symbol. The warning symbol precedes safety instructions. Make sure the child understands these instructions. Failure to follow these instructions may result in injury to the rider or to others, or damage to the product.

### ⚠️ WARNING TO AVOID SERIOUS INJURY:

- Adult assembly required.
- CHOKING HAZARD: Small parts. Not for children under 3 years.
  - Keep small loose parts and plastic bags out of the reach of children.
  - Not suitable for children under 3 years as foam pieces may break off and pose a choking hazard.
- An adult must unfold and fold this product (as equipped).
- Continuous adult supervision required.
- Never use near motor vehicles.
- Never ride with more than one person (unless equipped with rear step).
- Excessive weight may cause a hazardous or unstable condition.
- Protective equipment should be worn.
- Do not allow a child to ride without a CPSC approved helmet, with the chinstrap securely fastened.
- Always wear shoes when using this product.
- Not to be use in traffic.
- Do not allow a child to ride the product at dusk, at night or at times of limited visibility.
- Do not allow a child to ride on roadways or alleys.
- Do not allow a child to ride off road, on grass or wet surfaces.
- Never use near streets, swimming pools (or other bodies of water), hills, steps, or sloped driveways.
- For use on smooth paved surfaces only.
- Understand all operating procedures before use.
- Do not tow or pull any objects with the product.
- Do not push or pull a child riding on the product.
- Use with caution, since skill is required to avoid falls or collisions causing injury to the user or third parties.
- Always comply with local laws and regulations.
- If anything does not operate properly, discontinue use.
- Replace worn or broken parts immediately with genuine replacement parts.
- Handlebar hand grip or tube end plugs should be replaced if damaged as bare tubes have been known to cause injury. All products with capped handlebar ends should be checked regularly to ensure that adequate protection for the ends of the handlebars are in place.

## Assemble the Fork and Handlebar

### STEP ONE:

- Place Fender (A) onto Fork Assembly (B) and insert up into frame Headtube (C) with Clamp Slot (D) facing BACK.
- Ensure Headtube Bushings (E) are fully seated.
- Place Clamp (F) fully down onto Fork Tube (D).

### STEP TWO:

- Attach Handlebar (G) to Steer Tube (H) using Screws, Washers and Nuts (I) as shown.
- Make sure handlebar curves **BACK** - and in the same direction as Lock Button (J).
- Tighten Nuts (I) securely.
- Ensure that Handlebar is adjusted so that Lock Button (J) is in TOP position (L).
- **NOTE:** Clamp (K) may need to be loosened - reference Adjusting Handlebar section as needed.
- Slide Clamp Cover (N) up onto bottom Steer Tube.
- Install this assembly down into Fork Tube (D) fully.
- Align Handlebar with Fork/Wheel Assembly and tighten Clamp (F) securely.

### STEP THREE:

- Slide Clamp Cover (N) down over Clamp (F).
- Adjust Handlebar to correct height for child using Lock Button (J) and Positioning Holes.
- Slide Twist Clamp top (K) down onto Bottom Twist Clamp and tighten hand-tight.

### ⚠️ WARNINGS:

- Ensure Handlebar and Front Wheel, turn easily.

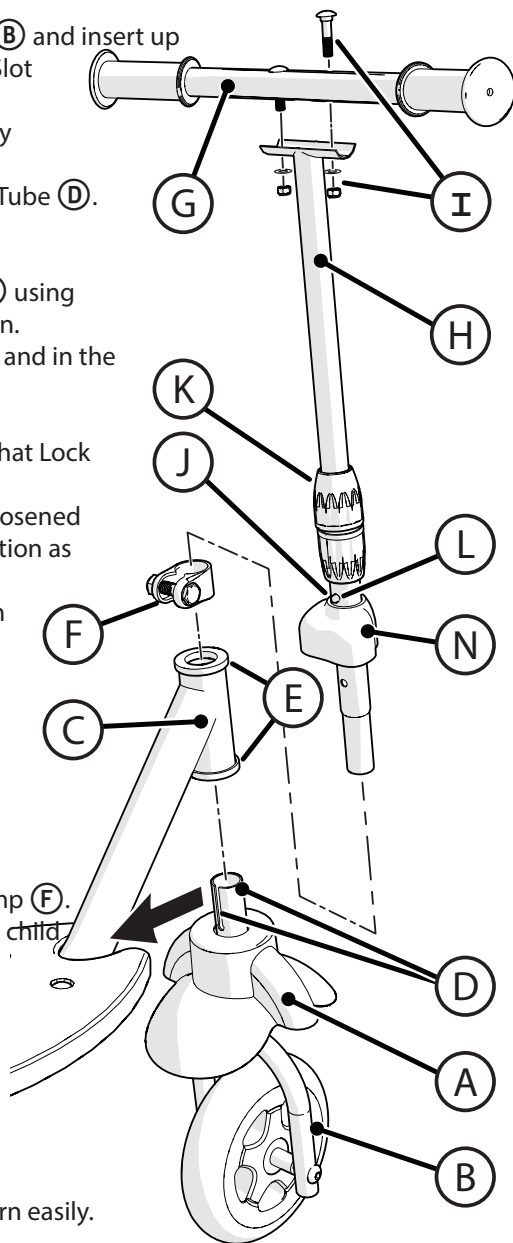

## Handlebar Bags/Pads (various models)

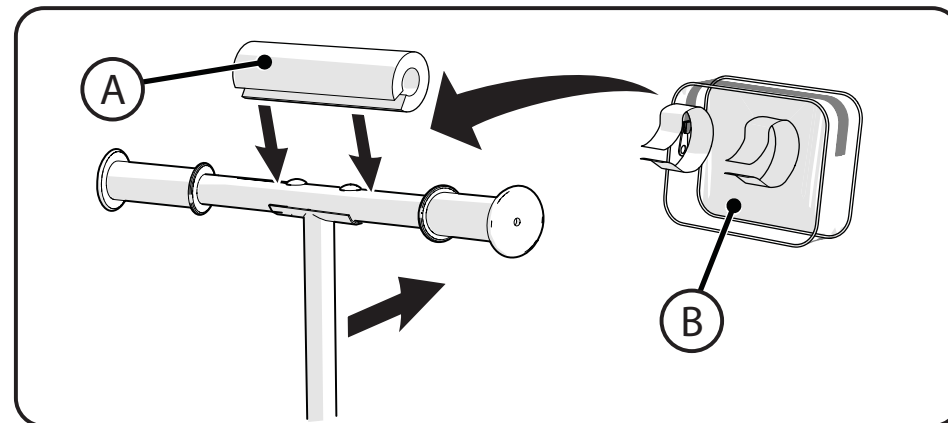

- Attach Handlebar Pad (A) (if equipped) to Handlebar by opening and placing straight down over handlebar and using Hook & Loop Straps to secure. Fasten securely.
- Attached Handlebar Bag (B) (if equipped) by securing bag straps around Handlebar/Bag. Fasten securely.

**⚠️ WARNING:**  
Bag Weight Limit: 5 lbs (2.3 kgs)